

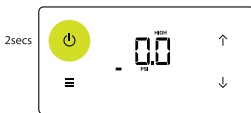

### Inflation Procedures

1.



To activate the pump, press and hold the power button (⏻) on the display.

2.



You can utilize the (+) and (-) buttons to choose the desired maximum PSI for your kite, wing, or SUP. The inflation process will cease automatically once this chosen setting is reached.

3.



After connecting the pump nozzle to your equipment, initiate the inflation process by pressing the power button (⏻)

### Motor Selector

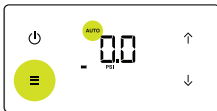

Quick press the mode (≡) button to switch between High Pressure, Low Pressure, or Auto Mode.

### Pressure Gauge Selector

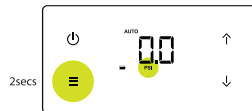

Long press the mode button (≡) to switch between PSI and BAR pressure display.

### Pressure Sensor Reset



With no hose or inflatable connected, long press both the (+) and (-) buttons until the screen displays RES. The pressure reading will then reset to zero.

**Reset only if necessary**

## Safety Warnings

- Do not operate the pump while charging.
- Before transporting the pump, ensure it is powered off.
- Always keep the air intake and outlet clear and unobstructed.
- To prevent injury, never point the inflation or intake port towards anyone.
- Do not use the pump if it appears to have water damage. Wipe off any moisture immediately.
- Do not leave the pump unattended during inflation or deflation to avoid accidents.
- Do not disconnect the air hose during inflation to prevent injury from high-pressure air release.
- Stop using the pump immediately if you hear abnormal noises or if it becomes excessively hot.
- Do not operate the pump continuously for more than 20 minutes to prevent motor overheating.
- Check the pressure tolerance of the inflatable product before use to avoid damage from overinflation.

Included in the box

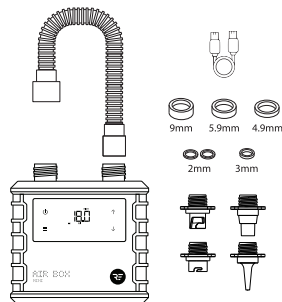

## Buttons Functions

Buttons	Short Press	Long Press
⏻ Power Button	Start/Stop Inflation	Power On/Off
≡ Mode Button	Switch Operation Modes	Switch Pressure Unit
⬆️ Plus Button	Increase Target Pressure	Increase Target Pressure Quickly
⬇️ Minus Button	Decrease Target Pressure	Increase Target Pressure Quickly

## Troubleshooting

Issue	Possible Cause	Solution
Cannot Power On	<ol style="list-style-type: none"> <li>1. Battery is empty</li> <li>2. Motor overload</li> <li>3. Hardware failure</li> </ol>	<p>Fully charge the pump, then try turning it on.</p> <p>If the problem persists, contact customer service.</p>
Can Power On, But Cannot Start Inflation	<ol style="list-style-type: none"> <li>1. Error code displayed</li> <li>2. Low battery</li> <li>3. Hardware failure</li> </ol>	<p>If there is an error code, refer to the error code instructions.</p> <p>If the battery is empty, fully charge the pump to activate it</p>
No Display When Plugged into Charger	<ol style="list-style-type: none"> <li>1. Charger or cable malfunction</li> <li>2. Hardware failure</li> </ol>	<p>Fully charge the pump, then try turning it on.</p> <p>If the problem persists, contact customer service.</p>
Charging Time Too Long	<ol style="list-style-type: none"> <li>1. Charger output power is too low</li> <li>2. Charging cable does not support high current</li> </ol>	<p>If there is an error code, refer to the error code instructions. If the battery is empty, fully charge the pump to activate it.</p>
Inflation Time Too Long	<ol style="list-style-type: none"> <li>1. Air hose is blocked or damaged</li> <li>2. Loose connection between hose and nozzle</li> </ol>	<p>Clear blockages, check for leaks, and reconnect or replace the hose or O-ring.</p> <p>Contact customer service if the issue persists.</p>

Codes	Cause	Solution
EE 1	Low-pressure pump current exceeds limit	Restart the pump and try inflating again.
EE 2	High-pressure pump current exceeds limit	Restart the pump and try inflating again.
EE 3	Charging current is too high or short circuit	Use a charger and cable supporting 5V 2A or above.
EE 4	Charging current is too low	Reconnect the charging cable. Use proper charger and cable (5V 2A+).
EE 5	Charging communication error	Reconnect the charging cable.
HOT	Internal temperature too high or fan malfunction	<p>- Avoid using the pump under direct sunlight for long periods.</p> <p>- If "HOT" appears, stop for 10 minutes before resuming.</p> <p>- Ensure the air nozzle is not blocked during operation.</p>

